

## 38 968 SH0 **EVEN ACTUATION PLATE**

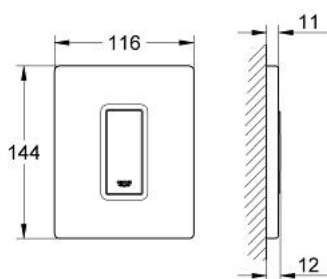

### PRODUCT DESCRIPTION

- Colour: alpine white
- manual activation for urinal
- set for final installation
- 116 x 144 mm
- mechanical functional cartridge
- flow pressure min 0.5 bar
- operating pressure max 6 bar
- 1.0 - 6.0 l adjustable
- low noise (group II according to German noise specification)



## 38 968 SH0 **EVEN ACTUATION PLATE**

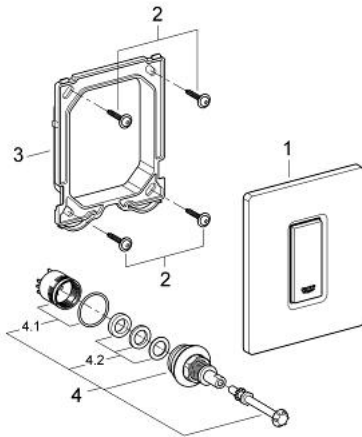

### **SPARE PARTS**, March 2012 – now

1: Top plate with push button (Spare part-nr. 42377SH0)

2: Screw (Spare part-nr. 6636200M)

3: Mounting frame (Spare part-nr. 66845000)

4: Cartridge (Spare part-nr. 42354000)

4.1: Seal kit (Spare part-nr. 4271500M)

4.2: Rings (Spare part-nr. 4282000M)