

36 070 000 **GROHE ONDUS CONCEALED BODY**



PRODUCT DESCRIPTION

- for use with:
- 36 054
- 36 058
- concealed installation
- function unit
- integrated temperature sensor
- plug power supply 120 V AC / 6 V DC
- integrated battery back up
- 6 V lithium battery, type CR-P2
- cables

36 070 000 GROHE ONDUS CONCEALED BODY

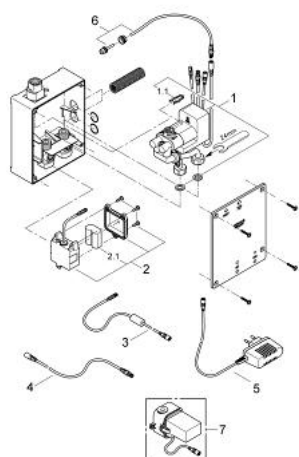

SPARE PARTS, July 2007 – now

- 1: Function unit (Spare part-nr. 42338000)
- 1.1: Fixing clamp (Spare part-nr. 6554100M)
- 2: Battery housing (Spare part-nr. 42741000)
- 2.1: Battery (Spare part-nr. 42886000)
- 3: Extension cable (Spare part-nr. 36221000)
- 4: Connection wire (Spare part-nr. 65815000)
- 5: Mains adaptor (Spare part-nr. 65912000)
- 6: Temperature sensor (Spare part-nr. 42349000)
- 7: Plug power supply 110-240 V (Spare part-nr. 36078000)*

* Optional accessories