

## 35 050 000 GROHE RAPIDO T THERMOSTATIC MIXER FOR CONCEALED INSTALLATION



### PRODUCT DESCRIPTION

- for use with bath-, shower- and central mixer
- without finishing trim set
- easy to install, premounted and tested unit
- GROHE TurboStat compact cartridge with wax thermoelement
- high flow rate up to 53 l/min. by use of three outlets at the same time
- two top outlets 1/2", lockable
- bottom outlet 1/2" can be used only with separate stop valve
- safe to install, stable built-in-box and protective cap
- fixation options for solid walls and dry cladding
- material for wall sealing included
- Aquadimmer-diverter for bath mixer or stop valve for shower mixer in finishing trim set
- body made of DR brass
- built-in non return valves and dirt strainers
- GROHE Water Saving - Less water, perfect flow
- min. recommended pressure 1.0 bar



## 35 050 000 **GROHE RAPIDO T THERMOSTATIC MIXER FOR CONCEALED INSTALLATION**

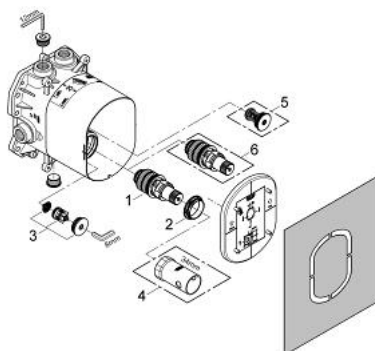

### **SPARE PARTS**, April 2013 – now

1: Thermostatic compact cartridge 3/4" (Spare part-nr. 47950000)

2: Fitting ring (Spare part-nr. 47765000)

3: Non-return valve (Spare part-nr. 47753000)

4: Socket spanner (Spare part-nr. 19332000)\*

5: Safety combination (EN 1717) (Spare part-nr. 29007000)\*

6: Thermostatic compact cartridge 3/4" for changed waterways (Spare part-nr. 47186000)\*

\* Optional accessories