

33 870 DC2 **BRIDGEFORD SINGLE-LEVER SINK MIXER 1/2"**



PRODUCT DESCRIPTION

- Colour: supersteel
- single hole installation
- swivel tubular spout
- swivel area 360°
- adjustable flow rate limiter
- pull-out dual spray - switches back and forth between regular flow and spray
- automatic returning
- integrated non-return valve
- diverter: mousseur/SpeedClean shower jet
- automatic return to mousseur
- flexible connection hoses
- rapid installation system from the top
- protected against backflow
- SpeedClean anti-limescale system
- GROHE SilkMove 35 mm ceramic cartridge
- projection 210 mm

33 870 DC2 **BRIDGEFORD SINGLE-LEVER SINK MIXER 1/2"**

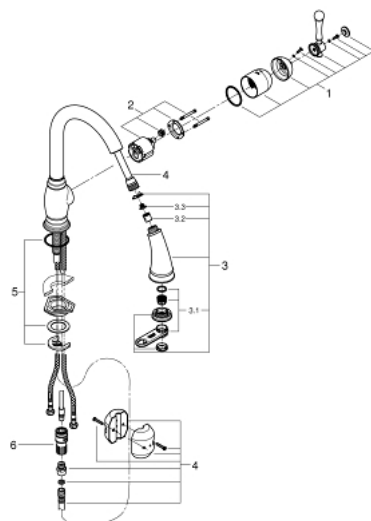

SPARE PARTS, November 2015 – now

- 1: lever US (Spare part-nr. 46593DC0)
- 2: Cartridge (Spare part-nr. 46048000)
- 3: Pull out spray (Spare part-nr. 46886ND0)
- 3.1: Mousseur (Spare part-nr. 46711000)
- 3.2: Non-return valve (Spare part-nr. 08565000)
- 3.3: Dirt strainer (Spare part-nr. 0676800M)
- 4: Shower hose (Spare part-nr. 46887000)
- 5: Shank mounting kit (Spare part-nr. 46345000)
- 6: Snap coupling (Spare part-nr. 48220000)