

33 870 001 **BRIDGEFORD SINGLE-LEVER SINK MIXER 1/2"**



**PRODUCT DESCRIPTION**

- Colour: chrome
- single hole installation
- swivel tubular spout
- swivel area 360°
- adjustable flow rate limiter
- pull-out dual spray - switches back and forth between regular flow and spray
- automatic returning
- integrated non-return valve
- diverter: mousseur/SpeedClean shower jet
- automatic return to mousseur
- flexible connection hoses
- rapid installation system from the top
- protected against backflow
- SpeedClean anti-limescale system
- GROHE SilkMove 35 mm ceramic cartridge
- projection 210 mm

## 33 870 001 BRIDGEFORD SINGLE-LEVER SINK MIXER 1/2"

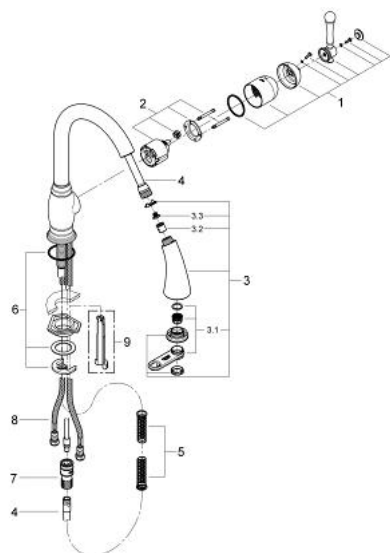

### SPARE PARTS, March 2011 – now

- 1: Lever (Spare part-nr. 46593000)
- 2: Cartridge (Spare part-nr. 46048000)
- 3: Pull out spray (Spare part-nr. 46875NC0)
- 3.1: Mousseur (Spare part-nr. 46711000)
- 3.2: Non-return valve (Spare part-nr. 08565000)
- 3.3: Dirt strainer (Spare part-nr. 0676800M)
- 4: Metalflex hose (Spare part-nr. 46174000)
- 5: Compression spring (Spare part-nr. 07240000)
- 6: Shank mounting kit (Spare part-nr. 46345000)
- 7: Snap coupling (Spare part-nr. 48220000)
- 8: Connecting hose (Spare part-nr. 46413000)
- 9: Disassembling key (Spare part-nr. 19132000)\*

\* Optional accessories