

32 298 SD1 **ZEDRA SINGLE-LEVER SINK MIXER 1/2"**



PRODUCT DESCRIPTION

- Colour: stainless steel
- single hole installation
- swivel tubular spout
- swivel area 360°
- adjustable flow rate limiter
- pull-out dual spray - switches back and forth between regular flow and spray
- automatic returning
- integrated non-return valve
- locking diverter: mousseur/SpeedClean shower jet
- automatic return to mousseur
- flexible connection hoses
- rapid installation system from the top
- protected against backflow
- SpeedClean anti-limescale system
- GROHE SilkMove 46 mm ceramic cartridge
- GROHE SuperSteel Infinity Finish
- GROHE RealSteel product material (stainless steel body)
- projection 211 mm
- forward rotation lever, does not hit backsplash

32 298 SD1 ZEDRA SINGLE-LEVER SINK MIXER 1/2"

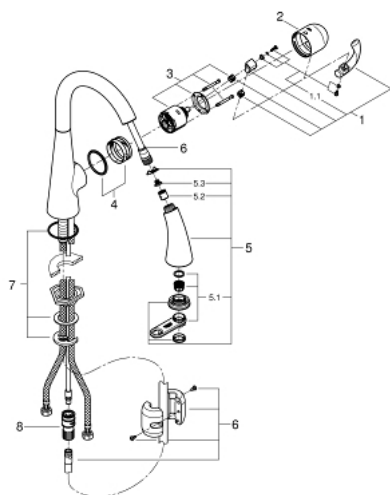

SPARE PARTS, November 2016 – now

- 1: Lever (Spare part-nr. 46654DC0)
- 1.1: Fixing set (Spare part-nr. 46310000)
- 2: Cap (Spare part-nr. 46655SD0)
- 3: Cartridge (Spare part-nr. 46048000)
- 4: Guide and slide ring (Spare part-nr. 46632V00)
- 5: Pull out spray (Spare part-nr. 46969ND0)
- 5.1: Mousseur (Spare part-nr. 46711000)
- 5.2: Non-return valve (Spare part-nr. 08565000)
- 5.3: Dirt strainer (Spare part-nr. 0676800M)
- 6: Hose for sink mixer with pull-out dual spray or mousseur (Spare part-nr. 48293000)
- 7: Shank mounting kit (Spare part-nr. 46345000)
- 8: Snap coupling (Spare part-nr. 48220000)