

32 296 SD0 ZEDRA SINGLE-LEVER SINK MIXER 1/2"



PRODUCT DESCRIPTION

- Colour: stainless steel
- single hole installation
- GROHE Long-Life finish
- GROHE RealSteel product material (stainless steel body)
- GROHE SilkMove 46 mm ceramic cartridge
- GROHE EasyDock guarantees easy retraction and smooth docking back to the starting position
- flow straightener
- pull-out laminar spray
- diverter: laminar spray/SpeedClean shower jet
- automatic return to laminar spray
- adjustable flow rate limiter
- swivel tubular spout
- swivel area 360°
- protected against backflow
- flexible connection hoses
- rapid installation system
- min. recommended pressure 1.0 bar



32 296 SD0 ZEDRA SINGLE-LEVER SINK MIXER 1/2"

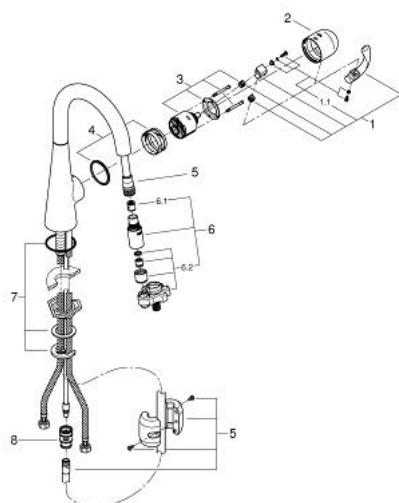

SPARE PARTS, November 2015 – now

- 1: Lever (Spare part-nr. 46654DC0)
- 1.1: Fixing set (Spare part-nr. 46310000)
- 2: Cap (Spare part-nr. 46655SD0)
- 3: Cartridge (Spare part-nr. 46048000)
- 4: Guide and slide ring (Spare part-nr. 46632V00)
- 5: Hose for sink mixer with pull-out dual spray or mousseur (Spare part-nr. 48293000)
- 6: Pull out spray (Spare part-nr. 46857DC0)
- 6.1: Non-return valve (Spare part-nr. 08565000)
- 6.2: Flow straightener (Spare part-nr. 13997000)
- 7: Shank mounting kit (Spare part-nr. 46345000)
- 8: Quick coupling (Spare part-nr. 46338000)