

32 073 SD0 **K4 SINGLE-LEVER SINK MIXER 1/2"**



PRODUCT DESCRIPTION

- Colour: stainless steel
- extractable trigger spray Dual integrated
- low version
- single hole installation
- GROHE SilkMove 35 mm ceramic cartridge
- GROHE RealSteel product material (stainless steel body)
- adjustable flow rate limiter
- swivel tubular spout
- projection 204 mm
- extractable pull out handspray integrated
- automatic returning
- integrated non-return valve
- diverter: mousseur/shower jet automatic return to mousseur
- SpeedClean anti-limescale system
- flexible connection hoses
- rapid installation system
- protected against backflow
- variable handle positioning
- lever
- coordinated K4 design

32 073 SD0 K4 SINGLE-LEVER SINK MIXER 1/2"

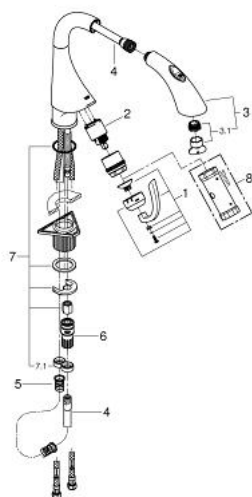

SPARE PARTS, March 2014 – now

- 1: Lever (Spare part-nr. 46572SD0)
- 2: Cartridge (Spare part-nr. 46374000)
- 3: Pull out spray (Spare part-nr. 46573DC0)
- 3.1: Mousseur (Spare part-nr. 13926000)
- 4: Metalflex hose (Spare part-nr. 46174000)
- 5: Compression spring (Spare part-nr. 07240000)
- 6: Snap coupling (Spare part-nr. 48220000)
- 7: Shank mounting kit (Spare part-nr. 46346000)
- 7.1: Stop (Spare part-nr. 04174000)
- 8: Socket spanner (Spare part-nr. 19332000)*

* Optional accessories