

## 32 071 00E **K4 SINGLE-LEVER SINK MIXER 1/2"**



### PRODUCT DESCRIPTION

- Colour: chrome
- extractable trigger spray Dual integrated
- high version
- single hole installation
- GROHE Water Saving - Less water, perfect flow
- GROHE SilkMove 35 mm ceramic cartridge
- GROHE Long-Life finish
- GROHE RealSteel product material (stainless steel body)
- adjustable flow rate limiter
- swivel tubular spout
- extractable pull out handspray integrated
- automatic returning
- integrated non-return valve
- diverter: mousseur/shower jet automatic return to mousseur
- SpeedClean anti-limescale system
- flexible connection hoses
- rapid installation system
- protected against backflow
- coordinated K4 design
- variable handle positioning
- lever
- projection 232 mm
- GROHE WaterCare

## 32 071 00E **K4 SINGLE-LEVER SINK MIXER 1/2"**

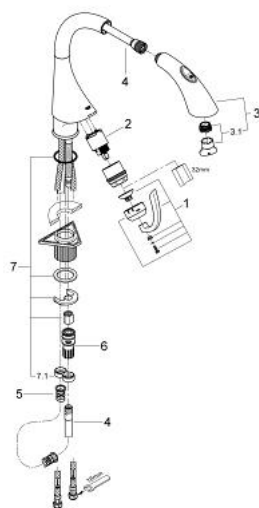

### **SPARE PARTS**, June 2010 – now

- 1: Lever (Spare part-nr. 46572000)
- 2: Cartridge (Spare part-nr. 46374000)
- 3: Pull out spray (Spare part-nr. 46573000)
- 3.1: Mousseur (Spare part-nr. 13926000)
- 4: Metalflex hose (Spare part-nr. 46174000)
- 5: Compression spring (Spare part-nr. 07240000)
- 6: Quick coupling (Spare part-nr. 46315000)
- 7: Shank mounting kit (Spare part-nr. 46346000)
- 7.1: Stop (Spare part-nr. 04174000)