

31 381 001 **GROHE BLUE MINTA CHILLED STARTER KIT**

PRODUCT DESCRIPTION

- Colour: chrome
- consisting of:
- GROHE Blue Minta single-lever sink mixer with filter function
- single hole installation
- separate handle for 3 types of filtered and chilled table water
- unchilled, medium chilled, full chilled
- headpart 1/2"
- GROHE SilkMove 35 mm ceramic cartridge
- adjustable flow rate limiter
- GROHE Long-Life finish
- swivel tubular spout
- separate inner water ways for filtered and non-filtered water
- swivel area 150°
- flexible connection hoses
- GROHE Blue Pure Cube
- 180 Watt cooling unit, 230 V, 50 Hz
- type of protection IP 21
- 6 V DC to filter change display unit
- adjustable for 600 litre, 1500 litre or 3000 litre filter cartridges
- CE approved
- GROHE Blue size S filter, filter head with flexible adjustment
- min. recommended pressure 2.0 bar

31 381 001 GROHE BLUE MINTA CHILLED STARTER KIT

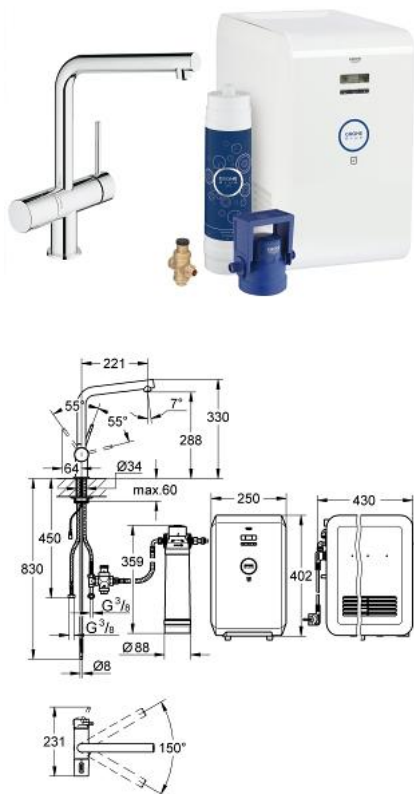
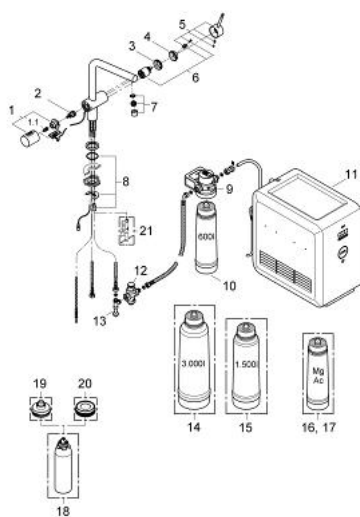

SPARE PARTS, May 2013 – now

- 1: Handle (Spare part-nr. 46652000)
- 1.1: Snap insert (Spare part-nr. 0538600M)
- 2: Headpart (Spare part-nr. 46713000)
- 3: Screw coupling (Spare part-nr. 46460000)
- 4: Cap (Spare part-nr. 46116000)
- 5: Lever (Spare part-nr. 48193000)
- 6: Cartridge (Spare part-nr. 46374000)
- 7: Mousseur (Spare part-nr. 48194000)
- 8: Shank mounting kit (Spare part-nr. 46249000)
- 9: Filter head (Spare part-nr. 64508001)
- 10: Filter S-Size (Spare part-nr. 40404001)
- 11: Chiller (Spare part-nr. 40693000)
- 12: Pressure reducing valve (Spare part-nr. 40452000)
- 13: Original WAS® T-piece 3/8" (Spare part-nr. 41007000)
- 14: Filter L-Size (Spare part-nr. 40412001)*
- 15: Filter M-Size (Spare part-nr. 40430001)*
- 16: Activated carbon filter (Spare part-nr. 40547001)*
- 17: Magnesium+ filter (Spare part-nr. 40691001)*
- 18: Cleaning cartridge (Spare part-nr. 40434001)*
- 19: Cleaning cartridge adapter (Spare part-nr. 40694000)*
- 20: Cleaning cartridge for adapter set (Spare part-nr. 40699000)*
- 21: Mounting wrench (Spare part-nr. 19017000)*

* Optional accessories