

## 30 314 DC0 K7 FOOT CONTROL ELECTRONIC SINGLE-LEVER SINK MIXER 1/2"



### PRODUCT DESCRIPTION

- Colour: supersteel
- medium spout
- Foot control: activation of water via contact with sensor
- battery supply 6 V lithium-battery, type CR-P2
- CE approved
- solenoid valve
- fixed value mixing valve
- automatic safety stop after 60 sec. (factory set)
- type of protection IP 44
- GROHE Long-Life finish
- GROHE SilkMove 35 mm ceramic cartridge
- professional spray
- diverter: mousseur/SpeedClean shower jet
- automatic return to mousseur
- adjustable flow rate limiter
- swivel tubular spout
- swivel area 360°
- protected against backflow
- flexible connection hoses
- rapid installation system

## 30 314 DC0 K7 FOOT CONTROL ELECTRONIC SINGLE-LEVER SINK MIXER 1/2"

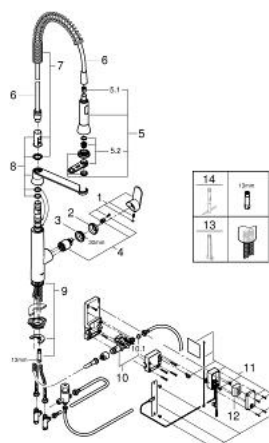

### SPARE PARTS, July 2015 – now

- 1: Lever (Spare part-nr. 46729DC0)
- 2: Cap (Spare part-nr. 46116DC0)
- 3: Screw coupling (Spare part-nr. 46460000)
- 4: Cartridge (Spare part-nr. 46374000)
- 5: Pull out spray (Spare part-nr. 46731DC0)
- 5.1: Non-return valve (Spare part-nr. 08565000)
- 5.2: Mousseur (Spare part-nr. 46711000)
- 6: Shower hose (Spare part-nr. 46871DC0)
- 7: Spring (Spare part-nr. 46873SD0)
- 8: Holder pull out spray (Spare part-nr. 46734DC0)
- 9: Shank mounting kit (Spare part-nr. 46671000)
- 10: Solenoid valve (Spare part-nr. 48213000)
- 10.1: Non-return valve (Spare part-nr. 08565000)
- 10.2: Dirt strainer (Spare part-nr. 42395000)
- 11: Control unit (Spare part-nr. 48304000)
- 12: Battery (Spare part-nr. 42886000)
- 13: Disassembling key (Spare part-nr. 19132000)\*
- 14: Mounting wrench (Spare part-nr. 19017000)\*

\* Optional accessories