

28 398 R00 MOVARIO SHOWER RAIL 900 MM

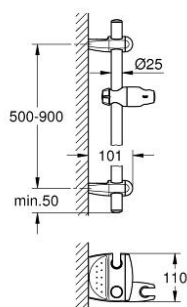

PRODUCT DESCRIPTION

- wall mounted
- adjustable distance between wall shower holders for adaption to existing drillings
- glide element with swivel holder
- wall brackets with trays and integrated shower holder
- GROHE FastFixation Plus (adjustable distance between wall shower holders for adaption to existing drillings)
- GROHE Long-Life finish
- shower rail, 600 mm



28 398 R00 **MOVARIO SHOWER RAIL 900 MM**

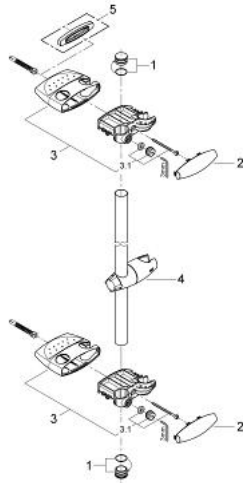

SPARE PARTS, January 2002 – now

- 1: Cover cap (Spare part-nr. 45922R00)
- 2: Cover plate (Spare part-nr. 11482R00)
- 3: Bracket (Spare part-nr. 45923RA0)
- 3.1: Fixing set (Spare part-nr. 45924000)
- 4: Glide element (Spare part-nr. 12353R00)
- 5: Compensation disc (Spare part-nr. 28407000)*

* Optional accessories