

## 26 361 000 RAINSHOWER SYSTEM SMARTCONTROL MONO 360 SHOWER SYSTEM WITH THERMOSTAT FOR WALL MOUNTING

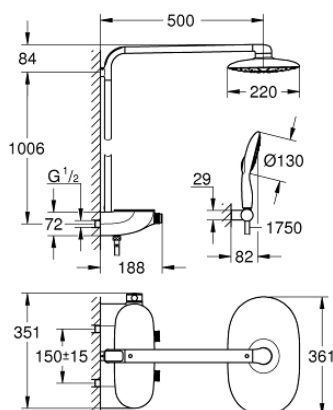

### PRODUCT DESCRIPTION

- Colour: chrome
- consisting of:
  - horizontal 500 mm shower arm
  - exposed SmartControl thermostat
  - allows change between:
    - head shower Rainshower Mono 360, spray plate chrome
    - GROHE PureRain/GROHE Rain O<sup>2</sup> spray\*
    - Power&Soul 130 hand shower, spray plate white (27 673)
  - hand shower wall holder (27 055)
  - Silverflex shower hose 1750 mm 1/2" x 1/2" (28 388)
- minimum flow rate 10 l/min
- GROHE DreamSpray perfect spray pattern
- GROHE Long-Life finish
- GROHE CoolTouch no risk of scalding
- GROHE TurboStat compact cartridge with wax thermoelement
- GROHE Water Saving - Less water, perfect flow
- GROHE SafeStop safety button at 38°C
- GROHE SafeStop Plus optional temperature limiter at 43°C included
- GROHE SmartControl push for ON-OFF, turn for volume adjustment from GROHE Water Saving to Full Flow
- GROHE EasyReach shower tray
- SpeedClean anti-limescale system
- Inner WaterGuide for a longer life
- suitable for instantaneous heaters from 18 kW/h
- TwistStop to prevent hose from twisting
- \* to be decided at first installation; factory default setting: GROHE PureRain



## 26 361 000 RAINSHOWER SYSTEM SMARTCONTROL MONO 360 SHOWER SYSTEM WITH THERMOSTAT FOR WALL MOUNTING



### SPARE PARTS, October 2018 – now

- 1: Thermostatic compact cartridge 1/2" (Spare part-nr. 47439000)
  - 2: Cartridge (Spare part-nr. 48297000)
  - 3: Non-return valve (Spare part-nr. 4901000M)
  - 4: Non-return valve (Spare part-nr. 08565000)
  - 5: Dirt strainer (Spare part-nr. 0700200M)
  - 6: Cover (Spare part-nr. 48482000)
  - 7: Socket spanner (Spare part-nr. 49059000)\*
  - 8: GROHE TurboStat cartridge 1/2" (Spare part-nr. 47175000)\*
  - 9: Compensation disc (Spare part-nr. 26385000)\*
  - 10: Shower system pipe for retrofitting (Spare part-nr. 48349000)\*
  - 11: Shower system pipe for retrofitting (Spare part-nr. 48350000)\*
- \* Optional accessories