

25 086 000 AVINA BATH MIXER 1/2"

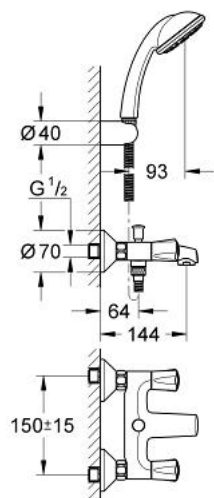

PRODUCT DESCRIPTION

- Colour: chrome
- wall mounted
- metal handles
- heat insulated
- screwable
- Carbodur headpart
- automatic diverter: bath/shower
- mousseur
- S-unions
- with Tempesta shower set
- consisting of:
 - hand shower Single (28 212)
 - wall shower holder (28 605)
 - shower hose Relaxaflex 1500 mm 1/2" x 1/2" (28 151)
- GROHE Long-Life finish

25 086 000 AVINA BATH MIXER 1/2"

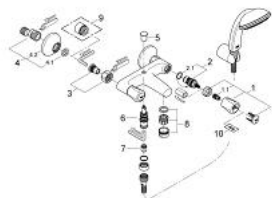

SPARE PARTS, June 2007 – now

- 1: Handle Atlanta (Spare part-nr. 45993000)
 - 1.1: Snap insert (Spare part-nr. 0538600M)
 - 2: Ceramic headpart 1/2" (Spare part-nr. 45346000)
 - 2.1: O-ring Ø 18.2 x Ø 1.7 (Spare part-nr. 0392400M)
 - 3: Screw connection (Spare part-nr. 45544000)
 - 4: S-union (Spare part-nr. 12075000)
 - 4.1: Seal (Spare part-nr. 0138600M)
 - 4.2: Escutcheon (Spare part-nr. 0221000M)
 - 5: Diverter knob (Spare part-nr. 65648000)
 - 6: Diverter (Spare part-nr. 65655000)
 - 7: Non-return valve (Spare part-nr. 08565000)
 - 8: Mousseur (Spare part-nr. 13927000)
 - 9: Extension 3/4", 20 mm (Spare part-nr. 0713000M)*
 - 10: Screw for Costa/Avina products (Spare part-nr. 48013000)*
- * Optional accessories