

## 24 151 EN3 ATRIO THERMOSTATIC MIXER FOR 2 OUTLETS WITH INTEGRATED SHUT OFF/DIVERTER VALVE



### PRODUCT DESCRIPTION

- Colour: brushed nickel
- set for final installation for
- GROHE Rapido SmartBox (35 601)
- GROHE TurboStat compact cartridge with wax thermoelement
- GROHE Long-Life finish
- GROHE FastFixation escutcheon with covered shaft sealing and covered fixing
- metal escutcheon, retroactively 6° adjustable
- GROHE SafeStop safety button at 38°C
- GROHE SafeStop Plus temperature limiter at 115° F/46° C
- GROHE AquaDimmer, integrated shut off/diverter valve
- metal handles
- without roughing-in set
- optional Aquadimmer stop ring for shared function (14 060 000)

## 24 151 EN3 ATRIO THERMOSTATIC MIXER FOR 2 OUTLETS WITH INTEGRATED SHUT OFF/DIVERTER VALVE

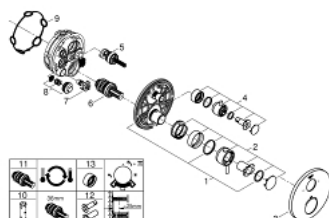

### SPARE PARTS, January 2018 – now

- 1: Mounting plate (Spare part-nr. 49080000)
- 2: Temperature control handle (Spare part-nr. 49089EN0)
- 3: Escutcheon (Spare part-nr. 49098EN0)
- 4: Shut-off handle Aquadimmer (Spare part-nr. 49165EN0)
- 5: Aquadimmer (Spare part-nr. 49084000)
- 6: Thermostatic compact cartridge 3/4" (Spare part-nr. 49028000)
- 7: Service stops (Spare part-nr. 1405300M)
- 8: Non-return valve (Spare part-nr. 49085000)
- 9: Seal (Spare part-nr. 48360000)
- 10: Socket spanner (Spare part-nr. 49059000)\*
- 11: GROHE TurboStat cartridge 3/4" (Spare part-nr. 49003000)\*
- 12: Universal extension set 2-handle thermostats, 25 mm (Spare part-nr. 14058000)\*
- 13: Aquadimmer stop ring for shared function (Spare part-nr. 14060000)\*

\* Optional accessories