

24 034 EN0 **GRANDERA TWO-HANDLE BIDET MIXER 1/2"**
M-SIZE



PRODUCT DESCRIPTION

- Colour: brushed nickel
- five hole installation
- valves hot/cold with ceramic headparts 1/2" - 90°
- GROHE Long-Life finish
- vertical spray and rim flush
- vacuum breaker
- combination transfer valve/pop-up lift rod
- flexible connection hoses

24 034 EN0 GRANDERA TWO-HANDLE BIDET MIXER 1/2" M-SIZE

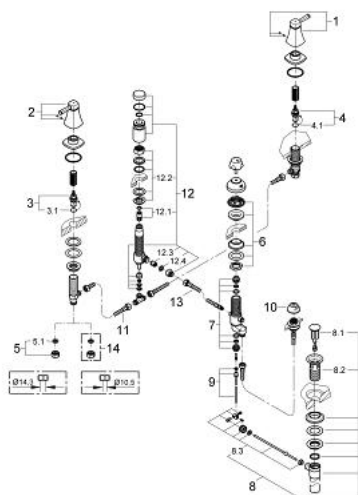

SPARE PARTS, June 2012 – now

- 1: Grandera handle blue (Spare part-nr. 48199EN0)
- 2: Grandera handle red (Spare part-nr. 48198EN0)
- 3: Ceramic headpart 1/2" (Spare part-nr. 45882000)
- 3.1: O-ring Ø 18.2 x Ø 1.7 (Spare part-nr. 0392400M)
- 4: Ceramic headpart 1/2" (Spare part-nr. 45883000)
- 4.1: O-ring Ø 18.2 x Ø 1.7 (Spare part-nr. 0392400M)
- 5: Coupling nut 1/2" x 14.5 mm (Spare part-nr. 1290200M)
- 5.1: Fibre seal Ø 18,5 x Ø 12 x 2 (Spare part-nr. 0138900M)
- 6: Screw connection M30 x 1.5 (Spare part-nr. 45026000)
- 7: Seal kit (Spare part-nr. 45027000)
- 8: Waste fitting (Spare part-nr. 28957EN0)
- 8.1: Plug (Spare part-nr. 45324EN0)
- 8.2: Housing (Spare part-nr. 01153EN0)
- 8.3: Ball rod (Spare part-nr. 45264000)
- 9: Swivel vertical pop-up rod (Spare part-nr. 45646000)
- 10: Spray faceplate (Spare part-nr. 02664EN0)
- 11: Flexible connection hose (Spare part-nr. 45704000)
- 12: Vacuum breaker (Spare part-nr. 45852EN0)
- 12.1: Shank mounting kit (Spare part-nr. 45855000)
- 12.2: Non-return valve (Spare part-nr. 08565000)
- 12.3: Fibre seal Ø 18,5 x Ø 12 x 2 (Spare part-nr. 0138900M)
- 13: Flexible connector M10 x 1 x M15 x 1 x 350 (Spare part-nr. 46254000)
- 14: Coupling nut 1/2" (Spare part-nr. 1290100M)*

* Optional accessories