

23 498 000 **GET PILLAR TAP 1/2" XS-SIZE**

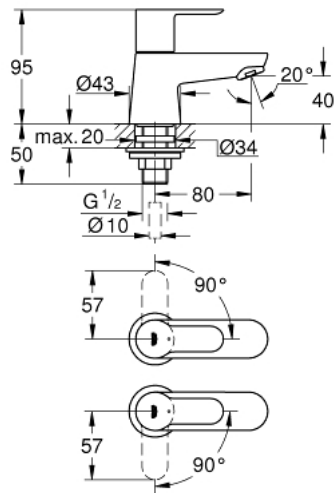

**PRODUCT DESCRIPTION**

- Colour: chrome
- single hole installation
- metal lever
- ceramic headpart 1/2", 90°
- GROHE Long-Life finish
- GROHE Water Saving - Less water, perfect flow
- mousseur
- 2 pieces
- min. recommended pressure 1.0 bar

## 23 498 000 GET PILLAR TAP 1/2" XS-SIZE

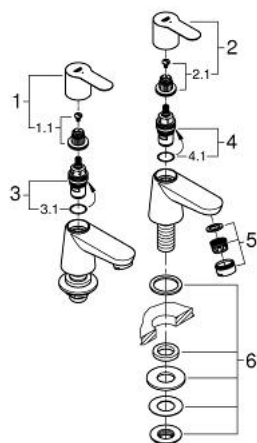

### SPARE PARTS, January 2014 – now

- 1: BauEdge handle red (Spare part-nr. 48246000)
- 1.1: Replacement handle connection kit (Spare part-nr. 45186000)
- 1.1.1: O-ring Ø 18.2 x Ø 1.7 (Spare part-nr. 0392400M)
- 2: Lever (Spare part-nr. 48028000)
- 2.1: Replacement handle connection kit (Spare part-nr. 45186000)
- 3: Ceramic headpart 1/2" (Spare part-nr. 45883000)
- 3.1: O-ring Ø 18.2 x Ø 1.7 (Spare part-nr. 0392400M)
- 4: Ceramic headpart 1/2" (Spare part-nr. 45882000)
- 4.1: O-ring Ø 18.2 x Ø 1.7 (Spare part-nr. 0392400M)
- 5: Laminar flow straightener (Spare part-nr. 64450000)
- 6: Shank fastening assembly 1/2" (Spare part-nr. 45000000)