

## 23 402 EN0 **AGIRA LAVATORY CENTERSET WITH ESCUTCHEON**



### **PRODUCT DESCRIPTION**

- Colour: brushed nickel
- GROHE Water Saving - Less water, perfect flow
- single hole installation
- metal lever
- GROHE SilkMove 28 mm ceramic cartridge
- GROHE Long-Life finish
- adjustable flow rate limiter
- adjustable minimum flow rate approx. 2.5 l/min
- mousseur
- pop-up waste set
- flexible connection hoses
- escutcheon
- rapid installation system
- includes metal pop-up
- 20" stainless steel braided steel flexible supply lines

## 23 402 EN0 **AGIRA LAVATORY CENTERSET WITH ESCUTCHEON**

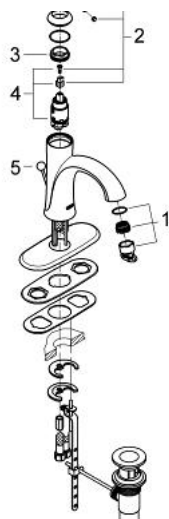

### **SPARE PARTS**, December 2012 – now

- 1: Mousseur (Spare part-nr. 13351000)
- 2: lever (Spare part-nr. 46879EN0)
- 3: Fitting ring (Spare part-nr. 07419000)
- 4: Cartridge (Spare part-nr. 46580000)
- 5: Pop-up rod (Spare part-nr. 06329EN0)