

20 800 00A **SEABURY THREE-HOLE BASIN MIXER 1/2"**



**PRODUCT DESCRIPTION**

- Colour: chrome
- without handles
- cast spout with mousseur
- ceramic headparts 1/2", 90°
- pop-up waste set 1 1/4"
- pressure-proof flexible connection hoses between spout and side valves
- for Seabury cross and lever handles 18 731 / 18 732
- GROHE Long-Life finish
- max. flow rate 4.5 l/min (1.2 gpm)

## 20 800 00A SEABURY THREE-HOLE BASIN MIXER 1/2"

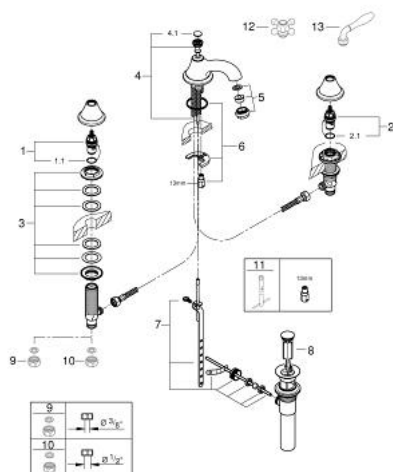

### SPARE PARTS, June 2015 – now

- 1: Ceramic headpart 1/2" (Spare part-nr. 45882000)
  - 1.1: O-ring Ø 18.2 x Ø 1.7 (Spare part-nr. 0392400M)
  - 2: Ceramic headpart 1/2" (Spare part-nr. 45883000)
  - 2.1: O-ring Ø 18.2 x Ø 1.7 (Spare part-nr. 0392400M)
  - 3: Counter screws M28 x 1.5 (Spare part-nr. 45025000)
  - 4: Pop-up rod (Spare part-nr. 45766000)
  - 4.1: Marking piece (Spare part-nr. 45763L00)
  - 5: Laminar flow straightener (Spare part-nr. 13931000)
  - 6: Shank mounting kit (Spare part-nr. 46249000)
  - 7: Ball rod (Spare part-nr. 48332000)
  - 8: Plug (Spare part-nr. 48331000)
  - 9: Coupling nut 1/2" (Spare part-nr. 1290100M)\*
  - 10: Coupling nut 1/2" x 14.5 mm (Spare part-nr. 1290200M)\*
  - 11: Mounting wrench (Spare part-nr. 19017000)\*
  - 12: Cross handle (Spare part-nr. 18731000)\*
  - 13: Lever handle (Spare part-nr. 18732000)\*
- \* Optional accessories