

20 418 ENA **GRANDERA THREE-HOLE BASIN MIXER 1/2"**
S-SIZE



PRODUCT DESCRIPTION

- Colour: brushed nickel
- valves hot/cold with ceramic headparts 1/2" - 90°
- GROHE Long-Life finish
- GROHE Water Saving - Less water, perfect flow
- GROHE AquaGuide adjustable mousseur 4.5 l/min
- pressure-proof flexible connection hoses between spout and side valves
- pop-up waste set 1 1/4"
- max. flow rate 4.5 l/min (1.2 gpm)

20 418 ENA **GRANDERA THREE-HOLE BASIN MIXER 1/2"** **S-SIZE**

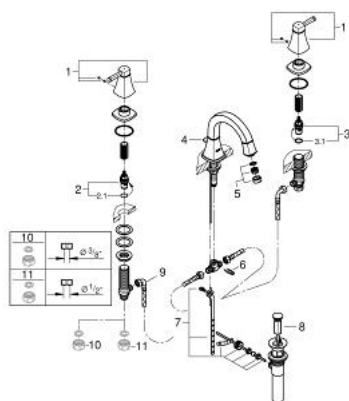

SPARE PARTS, June 2015 – now

- 1: Handle pair (Spare part-nr. 48325EN0)
- 2: Ceramic headpart 1/2" (Spare part-nr. 45882000)
- 2.1: O-ring Ø 18.2 x Ø 1.7 (Spare part-nr. 0392400M)
- 3: Ceramic headpart 1/2" (Spare part-nr. 45883000)
- 3.1: O-ring Ø 18.2 x Ø 1.7 (Spare part-nr. 0392400M)
- 4: Lift rod (Spare part-nr. 48200EN0)
- 5: Flow straightener (Spare part-nr. 48300EN0)
- 6: Fixing clamp (Spare part-nr. 6554100M)
- 7: Ball rod (Spare part-nr. 48332000)
- 9: Flexible connection hose (Spare part-nr. 45704000)
- 10: Coupling nut 1/2" (Spare part-nr. 1290100M)*
- 11: Coupling nut 1/2" x 14.5 mm (Spare part-nr. 1290200M)*

* Optional accessories