

## 20 390 ENA **PARKFIELD 8" LAVATORY WIDASET**



### PRODUCT DESCRIPTION

- Colour: brushed nickel
- GROHE Water Saving - Less water, perfect flow
- spout with mousseur
- GROHE Long-Life finish
- ceramic headparts 1/2", 90°
- pop-up waste set
- rapid installation system
- pressure-proof flexible connection hoses between spout and side valves
- max. flow rate 4.5 l/min (1.2 gpm)

## 20 390 ENA **PARKFIELD 8" LAVATORY WIDSET**

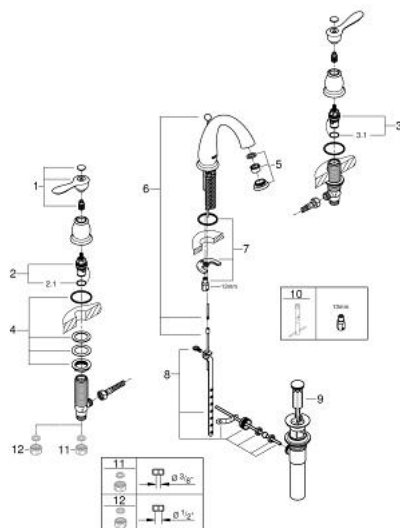

### SPARE PARTS, April 2016 – now

- 1: Parkfield lever blue/red US (Spare part-nr. 48205EN0)
- 2: Ceramic headpart 1/2" (Spare part-nr. 45882000)
- 2.1: O-ring Ø 18.2 x Ø 1.7 (Spare part-nr. 0392400M)
- 3: Ceramic headpart 1/2" (Spare part-nr. 45883000)
- 3.1: O-ring Ø 18.2 x Ø 1.7 (Spare part-nr. 0392400M)
- 4: Counter screws M28 x 1.5 (Spare part-nr. 45025000)
- 5: Mousseur (Spare part-nr. 46840EN0)
- 6: Pop-up rod (Spare part-nr. 48104EN0)
- 7: Shank fastening assembly (Spare part-nr. 46841000)
- 8: Ball rod (Spare part-nr. 48332000)
- 10: Mounting wrench (Spare part-nr. 19017000)\*
- 11: Coupling nut 1/2" (Spare part-nr. 1290100M)\*
- 12: Coupling nut 1/2" x 14.5 mm (Spare part-nr. 1290200M)\*

\* Optional accessories