

20 148 00A **ALLURE THREE-HOLE BASIN MIXER 1/2"**  
**M-SIZE**



**PRODUCT DESCRIPTION**

- Colour: chrome
- separate escutcheons made of metal
- Carbodur ceramic headparts 1/2", 180°
- spout with mousseur
- pressure-proof flexible connection hoses between spout and side valves
- pop-up waste set 1 1/4"
- max. flow rate 4.5 l/min (1.2 gpm)

## 20 148 00A **ALLURE THREE-HOLE BASIN MIXER 1/2"** **M-SIZE**

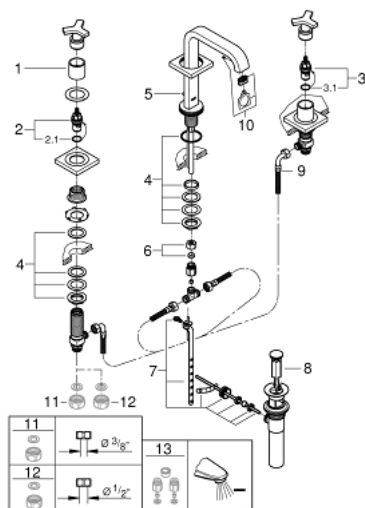

### SPARE PARTS, March 2020 – now

- 1: Sleeve (Spare part-nr. 08124000)
  - 2: Ceramic headpart 1/2" (Spare part-nr. 45882000)
  - 2.1: O-ring Ø 18.2 x Ø 1.7 (Spare part-nr. 0392400M)
  - 3: Ceramic headpart 1/2" (Spare part-nr. 45883000)
  - 3.1: O-ring Ø 18.2 x Ø 1.7 (Spare part-nr. 0392400M)
  - 4: Counter screws M28 x 1.5 (Spare part-nr. 45025000)
  - 5: Pop-up rod (Spare part-nr. 65196000)
  - 6: Compression union 3/8" (Spare part-nr. 12914000)
  - 7: Ball rod (Spare part-nr. 48332000)
  - 8: Plug (Spare part-nr. 48331000)
  - 9: Flexible connection hose (Spare part-nr. 45704000)
  - 10: Mousseur (Spare part-nr. 13220000)
  - 11: Coupling nut 1/2" (Spare part-nr. 1290100M)\*
  - 12: Coupling nut 1/2" x 14.5 mm (Spare part-nr. 1290200M)\*
  - 13: Water saving set (Spare part-nr. 48189000)\*
- \* Optional accessories