

20 121 EN1 **ARDEN THREE-HOLE BASIN MIXER 1/2"**



PRODUCT DESCRIPTION

- Colour: brushed nickel
- without handles
- cast spout with mousseur
- ceramic headparts 1/2", 90°
- pop-up waste set 1 1/4"
- pressure-proof flexible connection hoses between spout and side valves
- GROHE Long-Life finish

20 121 EN1 **ARDEN THREE-HOLE BASIN MIXER 1/2"**

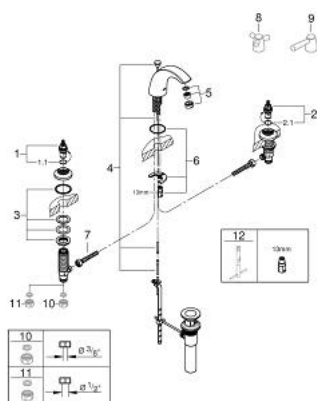

SPARE PARTS, February 2016 – now

- 1: Ceramic headpart 1/2" (Spare part-nr. 45882000)
- 1.1: O-ring Ø 18.2 x Ø 1.7 (Spare part-nr. 0392400M)
- 2: Ceramic headpart 1/2" (Spare part-nr. 45883000)
- 2.1: O-ring Ø 18.2 x Ø 1.7 (Spare part-nr. 0392400M)
- 3: Counter screws M28 x 1.5 (Spare part-nr. 45025000)
- 4: Pop-up rod (Spare part-nr. 48002000)
- 5: Mousseur (Spare part-nr. 48159EN0)
- 6: Shank mounting kit (Spare part-nr. 46249000)
- 7: Connection hose (Spare part-nr. 46255000)
- 8: Arden cross handles, pairs (Spare part-nr. 18084EN0)*
- 9: Arden lever handles, pairs (Spare part-nr. 18083EN0)*
- 10: Coupling nut 1/2" (Spare part-nr. 1290100M)*
- 11: Coupling nut 1/2" x 14.5 mm (Spare part-nr. 1290200M)*
- 12: Mounting wrench (Spare part-nr. 19017000)*

* Optional accessories