

## 20 121 EN0 **THREE-HOLE BASIN MIXER 1/2"**



### **PRODUCT DESCRIPTION**

- Colour: brushed nickel
- without handles
- cast spout with mousseur
- ceramic headparts 1/2", 90°
- pop-up waste set 1 1/4"
- pressure-proof flexible connection hoses between spout and side valves
- GROHE Long-Life finish

## 20 121 EN0 THREE-HOLE BASIN MIXER 1/2"

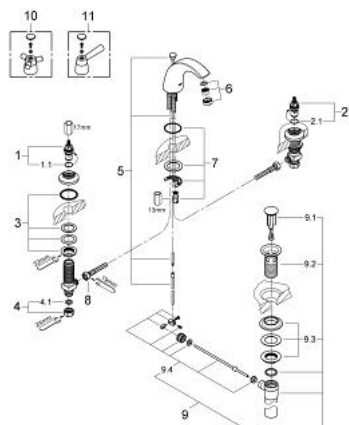

### SPARE PARTS, April 2008 – now

- 1: Ceramic headpart 1/2" (Spare part-nr. 45882000)
- 1.1: O-ring Ø 18.2 x Ø 1.7 (Spare part-nr. 0392400M)
- 2: Ceramic headpart 1/2" (Spare part-nr. 45883000)
- 2.1: O-ring Ø 18.2 x Ø 1.7 (Spare part-nr. 0392400M)
- 3: Counter screws M28 x 1.5 (Spare part-nr. 45025000)
- 4: Coupling nut 1/2" x 14.5 mm (Spare part-nr. 1290200M)
- 4.1: Fibre seal Ø 18,5 x Ø 12 x 2 (Spare part-nr. 0138900M)
- 5: Pop-up rod (Spare part-nr. 48002EN0)
- 6: Laminar flow straightener (Spare part-nr. 13955EN0)
- 7: Shank mounting kit (Spare part-nr. 46249000)
- 8: Connection hose (Spare part-nr. 46255000)
- 9: Waste fitting (Spare part-nr. 28957EN0)
- 9.1: Plug (Spare part-nr. 45324EN0)
- 9.2: Housing (Spare part-nr. 01153EN0)
- 9.3: Ball rod (Spare part-nr. 45264000)
- 10: Arden cross handles, pairs (Spare part-nr. 18084EN0)\*
- 11: Arden lever handles, pairs (Spare part-nr. 18083EN0)\*
- \* Optional accessories