

20 069 ENA **ATRIO THREE-HOLE BASIN MIXER 1/2"**
M-SIZE



PRODUCT DESCRIPTION

- Colour: brushed nickel
- high version
- without handles
- GROHE Long-Life finish
- GROHE SilkMove ceramic cartridge
- GROHE WaterCare
- Trio spoke handles 18 026 000 & 18 026 EN0 (sold separately)
- Atrio lever handles 18 027 000 & 18 027 EN0 (sold separately)
- max. flow rate 4.5 l/min (1.2 gpm)
- less handles – order (18 026) or (18 027) (sold separately)

20 069 ENA **ATRIO THREE-HOLE BASIN MIXER 1/2"** **M-SIZE**

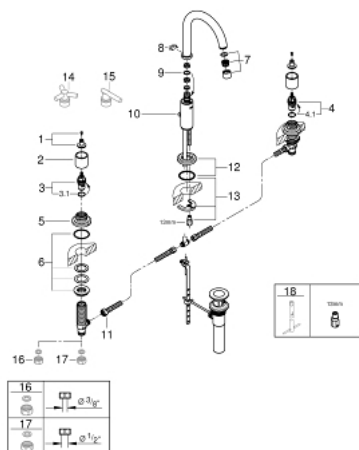

SPARE PARTS, June 2015 – now

- 1: Replacement handle connection kit (Spare part-nr. 45605000)
- 2: Sleeve (Spare part-nr. 08124EN0)
- 3: Ceramic headpart 1/2" (Spare part-nr. 45882000)
- 3.1: O-ring Ø 18.2 x Ø 1.7 (Spare part-nr. 0392400M)
- 4: Ceramic headpart 1/2" (Spare part-nr. 45883000)
- 4.1: O-ring Ø 18.2 x Ø 1.7 (Spare part-nr. 0392400M)
- 5: Escutcheon (Spare part-nr. 45630EN0)
- 6: Counter screws M28 x 1.5 (Spare part-nr. 45025000)
- 7: Flow control (Spare part-nr. 48302EN0)
- 8: Safety ring (Spare part-nr. 0806500M)
- 9: Sealing washer (Spare part-nr. 0128500M)
- 10: Pop-up rod (Spare part-nr. 06575EN0)
- 11: Flexible hose (Spare part-nr. 45442000)
- 12: Escutcheon (Spare part-nr. 45629EN0)
- 13: Shank mounting kit (Spare part-nr. 46249000)
- 14: Trio spoke handles (Spare part-nr. 18026EN0)*
- 15: Handle Jota (Spare part-nr. 18027EN0)*
- 16: Coupling nut 1/2" (Spare part-nr. 1290100M)*
- 17: Coupling nut 1/2" x 14.5 mm (Spare part-nr. 1290200M)*

* Optional accessories