

## 19 939 EN0 **GRANDERA DUAL FUNCTION THERMOSTATIC TRIM WITH CONTROL MODULE**



### **PRODUCT DESCRIPTION**

- Colour: brushed nickel
- GROHE Long-Life finish
- for shower head and non-diverter tub spout
- GROHE TurboStat technology
- integrated volume control
- 2-way diverter function
- 1 axis operation
- for use with GrohFlex universal rough-In box 35 026 000 sold separately
- GROHE SilkMove
- metal trim plate

## 19 939 EN0 GRANDERA DUAL FUNCTION THERMOSTATIC TRIM WITH CONTROL MODULE

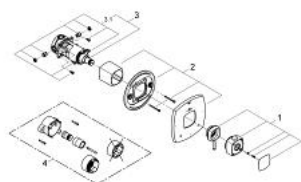

### **SPARE PARTS**, June 2012 – now

- 1: lever US (Spare part-nr. 47939EN0)
- 2: escutcheon US (Spare part-nr. 47940EN0)
- 3: Control unit THM kit #2 (Spare part-nr. 47853000)
- 3.1: non-return valves (Spare part-nr. 47851000)
- 4: Extension (Spare part-nr. 47889000)\*

\* Optional accessories