

19 927 000 EUROCUBE DUAL FUNCTION THERMOSTATIC TRIM WITH CONTROL MODULE



PRODUCT DESCRIPTION

- Colour: chrome
- for shower/tubs with non-diverter tub spout or for 2 shower outlet applications
- GROHE TurboStat technology
- integrated volume control
- 2-way diverter function
- 1 axis operation
- for use with GrohFlex universal rough-In box 35 026 000 sold separately
- flow rate:
- code compliance:
 - - ASME/ANSI A112.18.1M
 - - CSA Standard B125.1-05

19 927 000 EUROCUBE DUAL FUNCTION THERMOSTATIC TRIM WITH CONTROL MODULE

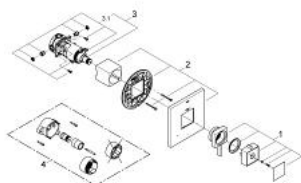

SPARE PARTS, April 2012 – now

- 1: lever US (Spare part-nr. 47897000)
- 2: escutcheon US (Spare part-nr. 47914000)
- 3: Control unit THM kit #2 (Spare part-nr. 47853000)
- 3.1: non-return valves (Spare part-nr. 47851000)
- 4: Extension (Spare part-nr. 47889000)*

* Optional accessories