

## 19 919 EN0 GRANDERA FIVE-HOLE BATH COMBINATION



### PRODUCT DESCRIPTION

- Colour: brushed nickel
- GROHE Long-Life finish
- consisting of:
- ceramic headparts 1/2", 90°
- pre-assembled spout fixing
- single lever mixer operating element
- bath spout with mousseur and diverter bath/shower
- Grandera hand shower 7.6 l
- metal shower hose 1500 mm
- connection for shower hose
- flexible connection hoses
- protected against backflow
- can be used with 29 037 000
- min. recommended pressure 1.0 bar

## 19 919 EN0 GRANDERA FIVE-HOLE BATH COMBINATION

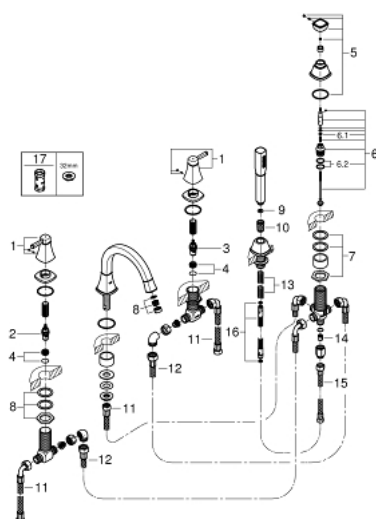

### SPARE PARTS, October 2018 – now

- 1: Handle pair (Spare part-nr. 48325EN0)
- 2: Ceramic headpart 3/4" (Spare part-nr. 45888000)
- 3: Ceramic headpart 3/4" (Spare part-nr. 45887000)
- 4: Valve seat 3/4" (Spare part-nr. 45345000)
- 5: diverter knob (Spare part-nr. 48216EN0)
- 6: Diverter (Spare part-nr. 45443000)
- 6.1: Sealing washer Ø 6 x Ø 2 (Spare part-nr. 0128300M)
- 6.2: Sealing washer (Spare part-nr. 0120500M)
- 7: Replacement kit for shank fastening (Spare part-nr. 45444000)
- 8: Mousseur (Spare part-nr. 13952EN0)
- 9: Dirt strainer (Spare part-nr. 0700200M)
- 10: Cone nut (Spare part-nr. 08864EN0)
- 11: Connecting hose (Spare part-nr. 48018000)
- 12: Connecting hose (Spare part-nr. 48019000)
- 13: Compression spring (Spare part-nr. 00869000)
- 14: Non-return valve (Spare part-nr. 08565000)
- 15: Connecting hose (Spare part-nr. 07300000)
- 16: Metal shower hose (Spare part-nr. 28146000)
- 17: Socket spanner (Spare part-nr. 19332000)\*

\* Optional accessories