

## 19 881 000 EUROPLUS DUAL FUNCTION PRESSURE BALANCE TRIM WITH CONTROL MODULE



### PRODUCT DESCRIPTION

- Colour: chrome
- for shower/tubs with non-diverter tub spout or for 2 shower outlet applications
- integrated volume control
- 2-way diverter function
- 1 axis operation
- for use with GrohFlex universal rough-In box 35 026 000 sold separately
- flow rate:
- code compliance:
- GROHE SilkMove
- ABS trim plate
- - ASME/ANSI A112.18.1M
- - CSA Standard B125.1-05
- ADA compliant
- GROHE Long-Life finish

## 19 881 000 EUROPLUS DUAL FUNCTION PRESSURE BALANCE TRIM WITH CONTROL MODULE

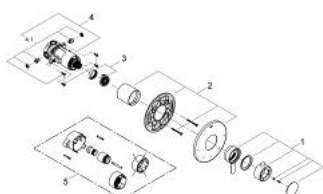

### SPARE PARTS, September 2010 – now

1: lever pressure balancing valve US (Spare part-nr. 47861000)

2: escutcheon US (Spare part-nr. 47862000)

3: handle adaptor US (Spare part-nr. 47863000)

4: control unit PBV kit # 2 US (Spare part-nr. 47864000)

4.1: non-return valves (Spare part-nr. 47851000)

5: GrohFlex Extension kit PBV (Spare part-nr. 47823000)\*

5: Extension (Spare part-nr. 47890000)\*

\* Optional accessories