

## 19 880 EN0 EUROPLUS SINGLE FUNCTION PRESSURE BALANCE TRIM WITH CONTROL MODULE



### PRODUCT DESCRIPTION

- Colour: brushed nickel
- for shower only or shower/tub with diverter applications
- integrated bypass option when used with diverter tub spout
- for use with GrohFlex universal rough-In box 35 026 000 sold separately
- flow rate:
- code compliance:
- GROHE SilkMove
- GROHE Long-Life finish
- - ASME/ANSI A112.18.1M
- - CSA Standard B125.1-05
- ADA compliant

## 19 880 EN0 EUROPLUS SINGLE FUNCTION PRESSURE BALANCE TRIM WITH CONTROL MODULE

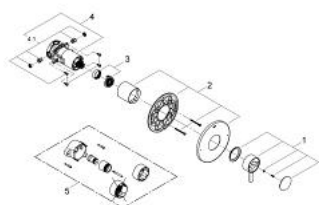

### SPARE PARTS, September 2010 – now

1: lever pressure balancing valve US (Spare part-nr. 47865EN0)

2: escutcheon US (Spare part-nr. 47866EN0)

3: handle adaptor US (Spare part-nr. 47863000)

4: Grohflex cartridge (Spare part-nr. 47857000)

4.1: non-return valves (Spare part-nr. 47851000)

5: GrohFlex Extension kit PBV (Spare part-nr. 47823000)\*

5: Extension (Spare part-nr. 47890000)\*

\* Optional accessories