

## 19 867 EN0 **ATRIO DUAL FUNCTION PRESSURE BALANCE TRIM WITH CONTROL MODULE**



### PRODUCT DESCRIPTION

- Colour: brushed nickel
- for shower/tubs with non-diverter tub spout or for 2 shower outlet applications
- integrated volume control
- 2-way diverter function
- 1 axis operation
- for use with GrohFlex universal rough-In box 35 026 000 sold separately
- flow rate:
- code compliance:
- ABS trim plate
- - ASME/ANSI A112.18.1M
- - CSA Standard B125.1-05
- ADA compliant
- GROHE Long-Life finish

## 19 867 EN0 **ATRIO DUAL FUNCTION PRESSURE BALANCE TRIM WITH CONTROL MODULE**

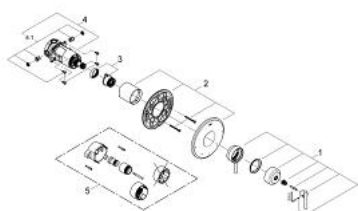

### **SPARE PARTS**, September 2010 – now

- 1: lever pressure balancing valve US (Spare part-nr. 47873EN0)
- 2: escutcheon US (Spare part-nr. 47874EN0)
- 3: handle adaptor US (Spare part-nr. 47863000)
- 4: Grohflex cartridge (Spare part-nr. 47860000)
- 4.1: non-return valves (Spare part-nr. 47851000)
- 5: GrohFlex Extension kit PBV (Spare part-nr. 47823000)\*

\* Optional accessories