

## 19 844 BE0 GROHTHERM 2000 AUTHENTIC DUAL FUNCTION PRESSURE BALANCE TRIM WITH CONTROL MODULE



### PRODUCT DESCRIPTION

- Colour: polished nickel
- for shower/tubs with non-diverter tub spout or for 2 shower outlet applications
- integrated volume control
- 2-way diverter function
- 1 axis operation
- for use with GrohFlex universal rough-In box 35 026 000 sold separately
- flow rate:
- code compliance:
- GROHE SilkMove
- GROHE Long-Life finish
- - ASME/ANSI A112.18.1M
- - CSA Standard B125.1-05
- ADA compliant

## 19 844 BE0 GROHTHERM 2000 AUTHENTIC DUAL FUNCTION PRESSURE BALANCE TRIM WITH CONTROL MODULE

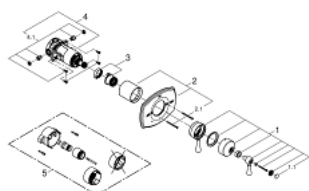

### SPARE PARTS, March 2018 – now

1: lever pressure balancing valve US (Spare part-nr. 47858BE0)

1.1: Marking piece (Spare part-nr. 45763L00)

2: escutcheon US (Spare part-nr. 47859BE0)

2.1: screws US (Spare part-nr. 47849BEM)

3: handle adaptor US (Spare part-nr. 47863000)

4: Grohflex cartridge (Spare part-nr. 47860000)

4.1: non-return valves (Spare part-nr. 47851000)

5: Extension (Spare part-nr. 47890000)\*

\* Optional accessories