

19 839 EN0 GROHTHERM 2000 AUTHENTIC CUSTOM SHOWER THERMOSTATIC TRIM WITH CONTROL MODULE



PRODUCT DESCRIPTION

- Colour: brushed nickel
- for high-flow, multiple outlet custom shower applications
- requires separate volume controls
- GROHE TurboStat technology
- for use with GrohFlex universal rough-in box 35 026 000 sold separately
- flow rate:
- code compliance:
 - - ASME/ANSI A112.18.1M
 - - CSA Standard B125.1-05

19 839 EN0 GROHTHERM 2000 AUTHENTIC CUSTOM SHOWER THERMOSTATIC TRIM WITH CONTROL MODULE

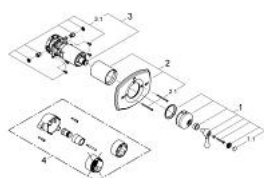

SPARE PARTS, September 2010 – now

- 1: Lever (Spare part-nr. 47847EN0)
- 1.1: Marking piece (Spare part-nr. 45763L00)
- 2: escutcheon US (Spare part-nr. 47854EN0)
- 2.1: screws US (Spare part-nr. 47849ENM)
- 3: Grohflex cartridge (Spare part-nr. 47855000)
- 3.1: non-return valves (Spare part-nr. 47851000)
- 4: Extension (Spare part-nr. 47822000)*

* Optional accessories