

## 19 825 BE0 GROHTHERM 2000 AUTHENTIC DUAL FUNCTION THERMOSTATIC TRIM WITH CONTROL MODULE



### PRODUCT DESCRIPTION

- Colour: polished nickel
- for shower/tubs with non-diverter tub spout or for 2 shower outlet applications
- GROHE TurboStat technology
- integrated volume control
- 2-way diverter function
- 1 axis operation
- for use with GrohFlex universal rough-in box 35 026 000 sold separately
- flow rate:
- code compliance:
- GROHE SilkMove
- GROHE Long-Life finish
- ABS trim plate
- - ASME/ANSI A112.18.1M
- - CSA Standard B125.1-05

## 19 825 BE0 GROHTHERM 2000 AUTHENTIC DUAL FUNCTION THERMOSTATIC TRIM WITH CONTROL MODULE

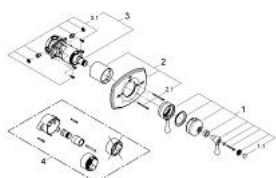

### SPARE PARTS, September 2010 – now

- 1: Lever (Spare part-nr. 47847BE0)
- 1.1: Marking piece (Spare part-nr. 45763L00)
- 2: Escutcheon (Spare part-nr. 47852BE0)
- 2.1: screws US (Spare part-nr. 47849BEM)
- 3: Control unit THM kit #2 (Spare part-nr. 47853000)
- 3.1: non-return valves (Spare part-nr. 47851000)
- 4: Extension (Spare part-nr. 47822000)\*

\* Optional accessories