

19 822 EN0 GROHFLEX 2000 SINGLE FUNCTION THERMOSTATIC TRIM WITH CONTROL MODULE



PRODUCT DESCRIPTION

- Colour: brushed nickel
- for shower only or shower/tub with diverter applications
- GROHE TurboStat technology
- integrated volume control
- integrated bypass option when used with diverter tub spout
- 1 axis operation
- for use with GrohFlex universal rough-In box 35 026 000 sold separately
- flow rate:
- code compliance:
- GROHE SilkMove
- GROHE Long-Life finish
- - ASME/ANSI A112.18.1M
- - CSA Standard B125.1-05

19 822 EN0 GROHFLEX 2000 SINGLE FUNCTION THERMOSTATIC TRIM WITH CONTROL MODULE

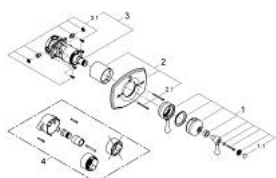

SPARE PARTS, September 2010 – now

- 1: Lever (Spare part-nr. 47847EN0)
- 1.1: Marking piece (Spare part-nr. 45763L00)
- 2: escutcheon US (Spare part-nr. 47848EN0)
- 2.1: screws US (Spare part-nr. 47849ENM)
- 3: Grohflex cartridge (Spare part-nr. 47850000)
- 3.1: non-return valves (Spare part-nr. 47851000)
- 4: Extension (Spare part-nr. 47822000)*

* Optional accessories