

## 19 707 BE0 SEABURY PRESSURE BALANCE VALVE TRIMSET



### PRODUCT DESCRIPTION

- Colour: polished nickel
- with cross handle
- set for final installation for
- 35 250, 35 251, 35 252, 35 253
- without concealed body
- escutcheon with wall sealing
- to replace the standard white caps use 45 952
- GROHE Long-Life finish
- for use with Grohsafe rough-in valve 35 015

## 19 707 BE0 SEABURY PRESSURE BALANCE VALVE TRIMSET

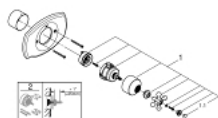

### SPARE PARTS, October 2016 – now

1: Pressure balance valve handle (Spare part-nr. 47703BE0)

1.1: Marking piece (Spare part-nr. 45763L00)

2: Extension (Spare part-nr. 47996000)\*

\* Optional accessories