

19 364 KS0 **VERIS THERMOSTAT WITH INTEGRATED 2-WAY DIVERTER FOR BATH OR SHOWER WITH MORE THAN ONE OUTLET**



PRODUCT DESCRIPTION

- Colour: velvet black
- set for final installation for
- GROHE Rapido T 35 500 000
- without concealed body
- GROHE Long-Life finish
- GROHE SafeStop Plus integrated temperature limiter at max 50° C
- Aquadimmer with multiple function
- shut off and flow control
- diverter for 2 outlets
- metal handles
- GROHE FastFixation escutcheon with covered shaft sealing and covered fixing
- metal escutcheon
- ** KS0 and LS0 can be ordered (minimum quantity 100 pcs). Delivery time minimum 12 weeks.

19 364 KS0 **VERIS THERMOSTAT WITH INTEGRATED 2-WAY DIVERTER FOR BATH OR SHOWER WITH MORE THAN ONE OUTLET**

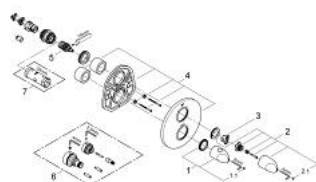

SPARE PARTS, November 2009 – now

- 1: Metal handle (Spare part-nr. 47729KS0)
- 1.1: Cover cap (Spare part-nr. 47818KSM)
- 2: Shut-off handle Aquadimmer (Spare part-nr. 47814KS0)
- 2.1: Cover cap (Spare part-nr. 47818KSM)
- 3: Stop ring (Spare part-nr. 10089000)
- 4: Escutcheon (Spare part-nr. 47816KS0)
- 5: Aquadimmer (Spare part-nr. 47364000)
- 6: Extension set 27.5 mm (Spare part-nr. 47781000)*
- 7: Socket spanner (Spare part-nr. 19332000)*

* Optional accessories