

19 263 EN0 TALIA CENTRAL THERMOSTATIC MIXER



PRODUCT DESCRIPTION

- Colour: brushed nickel
- set for final installation for
- 34 122
- 34 124
- without concealed body
- only useable with separate shut-off valves
- GROHE Long-Life finish

19 263 EN0 TALIA CENTRAL THERMOSTATIC MIXER

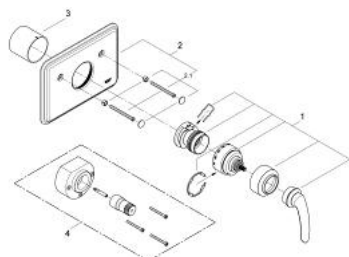

SPARE PARTS, June 2013 – now

1: thm handle w sc ring, talia 2 -bn (sp) (Spare part-nr. 47760EN0)

2: Escutcheon (Spare part-nr. 47589EN0)

2.1: Fixing set (Spare part-nr. 47336000)

3: Sleeve (Spare part-nr. 09949EN0)

4: Extension (Spare part-nr. 47820000)*

* Optional accessories