

19 222 BE0 **SEABURY 2-WAY DIVERTER**



PRODUCT DESCRIPTION

- Colour: polished nickel
- with cross handle
- set for final installation (for 29 712)
- without concealed body
- installation depth infinitely adjustable
- 22 - 60 mm
- to replace the standard white caps use 45 952
- GROHE Long-Life finish

19 222 BE0 SEABURY 2-WAY DIVERTER

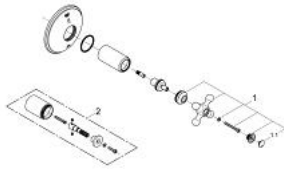

SPARE PARTS, January 2002 – now

1: Cross handle (Spare part-nr. 45764BE0)

1.1: Marking piece (Spare part-nr. 45763L00)

1.2: Fixing set (Spare part-nr. 47602000)

2: Extension (Spare part-nr. 45979000)*

* Optional accessories